

DOCK MASTER II

Model #: DM-2536U3
2.5" / 3.5" Dual Bay SSD & SATA Hard Drive Docking Station
Hot Plug & Play



*Hard Drive Not Included



www.kingwin.com

Kingwin Dock Master II 2.5" / 3.5" Dual Bay SSD & SATA Hard Drive Docking Station with USB 3.0

A new concept to easily access, or transfer data to your notebook or desktop PC.

Features:

- Model: DM-2536U3
- 2.5" / 3.5" Dual Bay SSD & SATA Hard Drive Docking Station
- Up to 4.8 Gbps Data Transfer Rate In USB 3.0
- Increase Storage Capacity to Any System
- Plug and Play
- Rohs Compliant
- LED for H.D.D. Access & Power

Specifications:

- H.D.D. Support: 2.5" / 3.5" SSD & SATA Hard Disc
- Dimension: 146 (W) x 115 (L) x 71 (H) mm
- Support OS: Windows 98SE/ME/2000/XP/Vista/7
Mac OS 10 x & Above
- Interface: USB 3.0

Identification of Buttons:

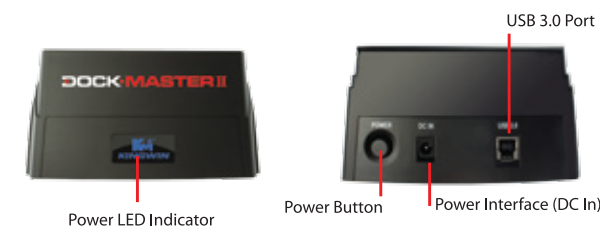

Installation:

1. Insert 2.5" or 3.5" SSD & SATA H.D.D.

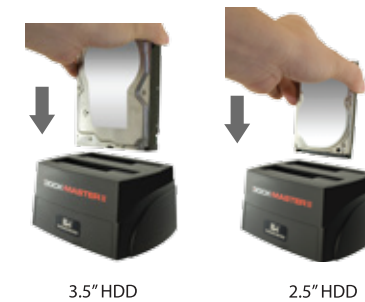

2. Connect Power Adapter to Dock Master II



3. Connect USB to Dock Master II



4. Attach the other end to your notebook or desktop PC



5. Power On



Un-Install:

1. Power Off



2. Unplug 2.5" or 3.5" SSD & SATA H.D.D. from top



Warning!
Please handle with care. Kingwin is not responsible for any software, hardware, or data lost within the hard drive.



DOCK MASTER II

Model #: DM-2536U3
2.5" / 3.5" Dual Bay SSD & SATA Hard Drive Docking Station
Hot Plug & Play

KWI Technology Inc. - U.S.A. (Headquarters)
4020 Valley Blvd, Unit 100
Walnut, CA 91789
TEL: 1-909-598-2888
FAX: 1-909-348-1133
E-MAIL: info@kingwin.com
WWW: http://www.kingwin.com